

PV110 Firmware Update Operation

1. Copy the firmware update file to a SD card;
2. Insert the SD card into the DVR;
3. Select Yes then press the Select Button  , then the firmware update dialog block will appear on the screen, as shown in the following Figure ,while updating ,please keep enough battery power or connect the AC adapter to AC power outlet and not to operate the DVR to avoid FW update failing

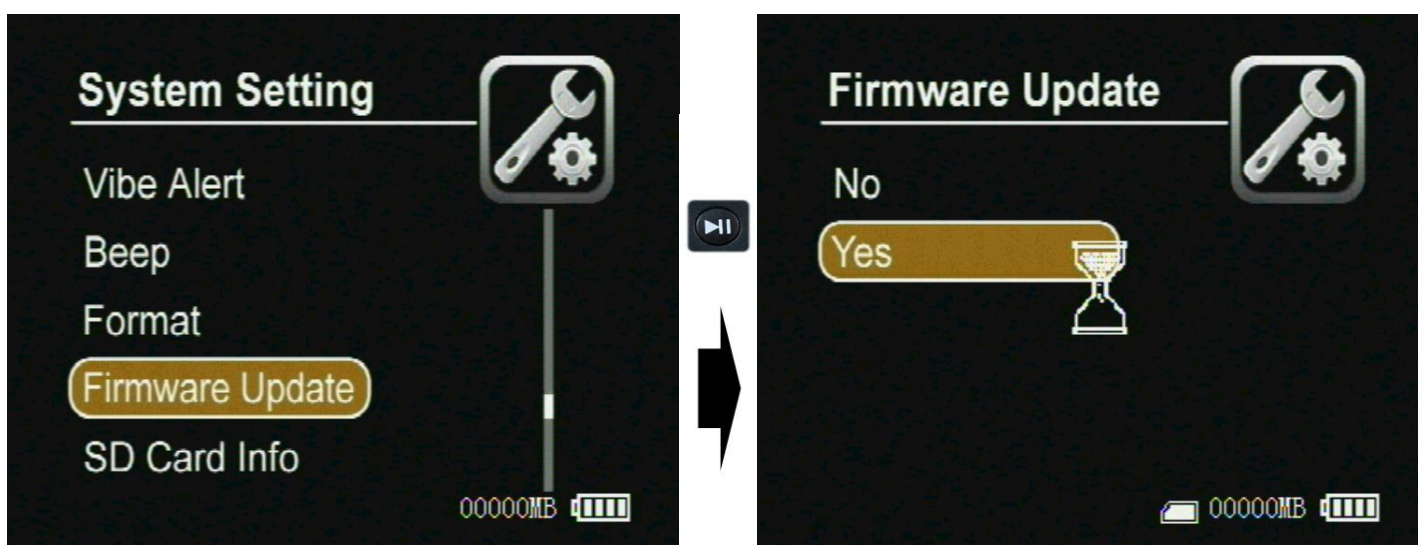

- **SD Card Info:** You can check the information on the current SD card.

●

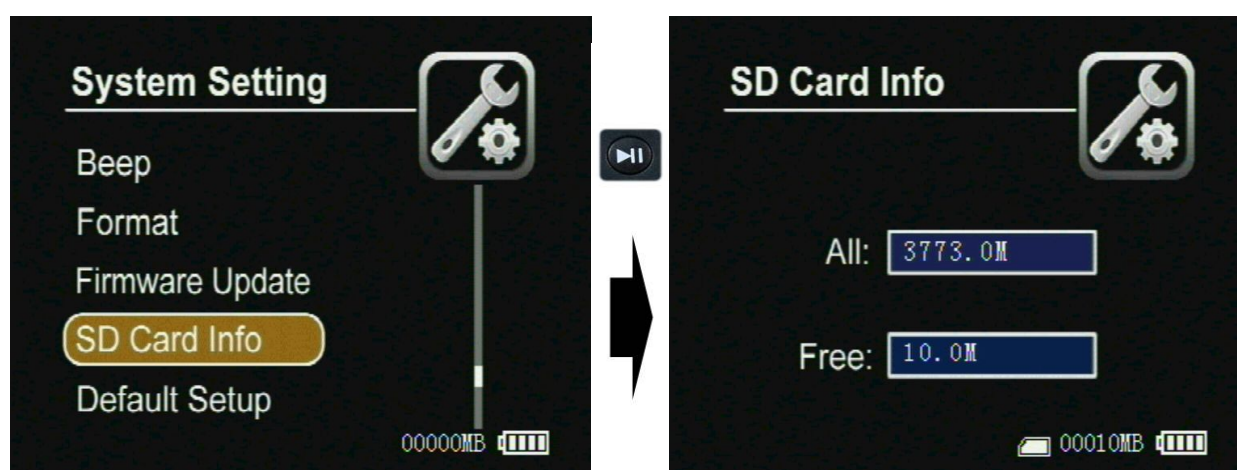

- **Default Setup:** You can reset the DVR to default setting if it is necessary; select the YES then to press the select button  to reset to default setting;

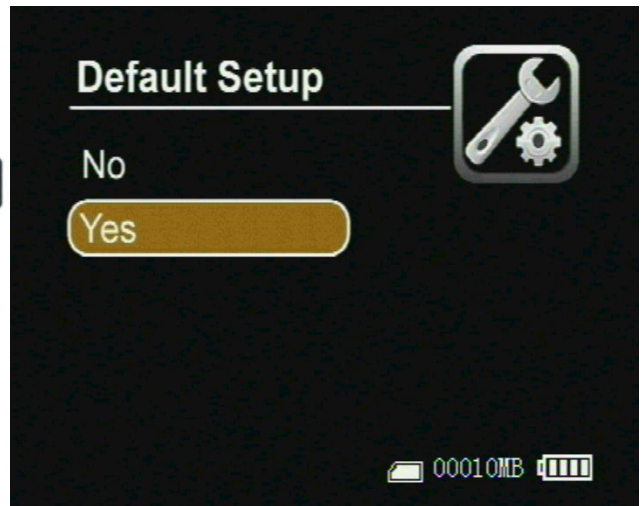
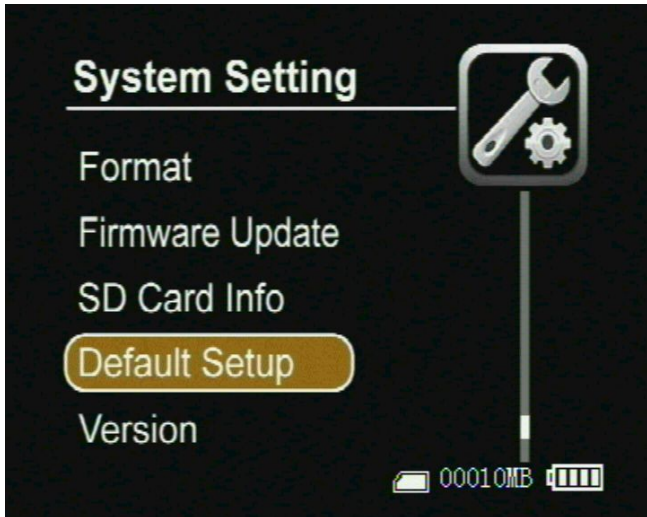

- **Version:** You can check the current FW version.
-

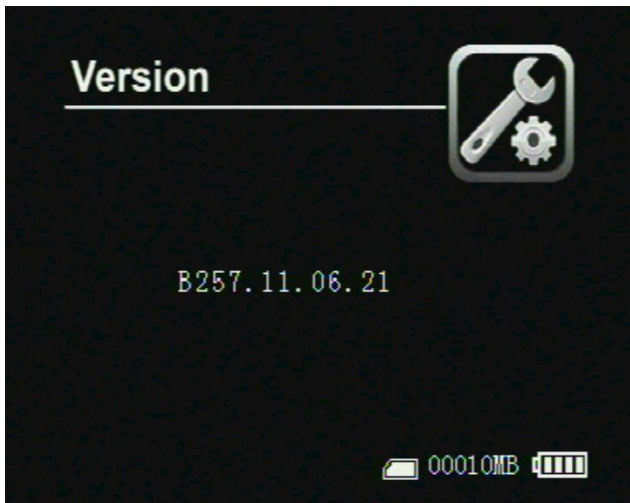

Any question, please contact us !

QQ:1732311546

Skype: xinyisales

Email: sales@camera-recorder.com

SHENZHEN XINYI TECHNOLOGY CO.,LTD